

## What's on the Horizon?

Some of our most interesting projects to-date will continue in 2018, including the FSU Student Union Renovation, while several will soon be complete. We're excited to kick-off our first Florida Welcome Center and other exciting new projects that will be intriguing and also challenging.

### PROJECT COMPLETIONS

Ringling Glass Pavilion (Sarasota, FL)  
 Jim Moran Building (Downtown Tallahassee)  
 Shores Innovation Hub (FSU Campus)  
 Arive850 Student Housing (Near FSU Campus)  
 Celebration Baptist Church Phase IV (Killbuck)

### PROJECT COMMENCEMENTS

New Restaurant in 201 E. Park Avenue Building  
 Visit Florida I-95 Welcome Center (Yulee, FL)  
 Bradfordville First Baptist Church (North Tallahassee)

ARIVE850



## Ringling Glass Art Pavilion Complete and Opening Soon

It's a wrap! We are pleased to announce the completion of the Kotler-Coville Glass Art Pavilion on FSU's Ringling Museum of Art campus in Sarasota, FL. The two-story, 5,500-square-foot space, adjacent to the visitors' pavilion, will showcase the museum's collection of over 200 pieces of studio art glass. "This has been one of our most unique and challenging projects to-date," Hays Layerd said. "Managing control of natural sunlight impacting a highly visible gallery was a challenge," Hays said. It was overcome through exterior-mounted, light-controlling fins made of anodized aluminum and sculpturally shaped to reflect the natural 'art' found in the shape of sand ripples impacted by ocean waves. The Museum will host a ribbon cutting ceremony on January 21, and the building opens to the public on January 22.

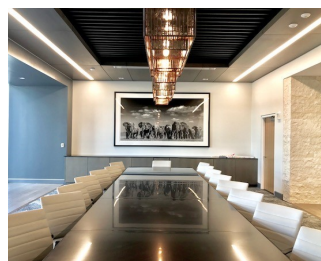
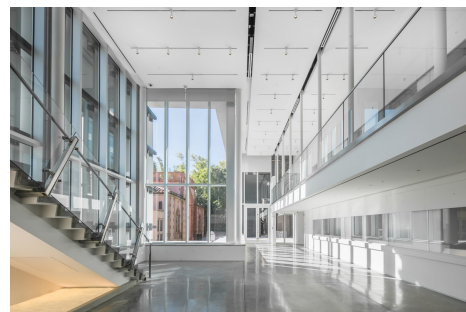

## Ballard Partners Moves Into 201 E. Park Avenue

One of downtown Tallahassee's newest buildings, 201 E. Park Avenue, on the corner of Park Avenue and Monroe Street is now occupied by Brian Ballard and his lobbying firm, Ballard Partners. The firm moved into the 5<sup>th</sup> and 6<sup>th</sup> floors just in time for the 2018 Legislative Session to begin. The first-floor lobby has a mix of materials and accessories that are both classic and whimsical. "From the porcelain marble floors, to the balloon chandeliers suspended from a gypsum cloud, this is a refreshing space," said ALW Interior Designer, Lindsey Grosso. The 5<sup>th</sup> and 6<sup>th</sup> floor

suites offer a sophisticated corporate environment with natural light that illuminates the space through sidelight windows in each office, as well as a folding window wall in the event room that opens to a lush terrace overlooking the Chain of Parks. The building's remaining floors are still being completed for various tenants, but are expected to be occupied by the end of the year.

## Design Award Received for Residence

In December, we received an award for excellence in design from AIA Tallahassee. The project consists of a 3,000-square foot residence (shown right) that was thoughtfully designed to respect the mass and scale of the surrounding, existing neighborhood while embracing a contemporary design inspired by light and materiality. Highlights of this residence include custom millwork, iconic masonry fireplaces, a large master suite with a day-lit walk-in closet, double shower opening into a garden, a large screened-in porch and swimming pool.

Barrier-free design concepts were employed throughout the design to allow the owners to age gracefully while enjoying a strong connection to the exterior environment.



## Connect and Stay Current With Us!

We frequently share updates and insights on our latest projects and studio activities. Be sure to connect with us at:

 **INSTAGRAM**  
@architects\_lw

 **FACEBOOK**  
@Architects.LewisWhitlock

 **TWITTER**  
@ArchitectsLW

## A Warm Welcome to Our New Design Intern from Puerto Rico

While some firms focus on recruiting talent as they graduate, we often place importance on students who are in the process of attaining their architecture and interior design degrees. Some of our talented designers currently on staff joined the firm as interns, and were offered full-time positions after graduating. Our Internship Program affords students from different universities the opportunity to experience first-hand exposure to real projects, interdisciplinary design and best practices. We are excited to welcome our new architectural design intern, Cristina Montenegro to ALW. Cristina is a native of Puerto Rico, where she earned her undergraduate degree in architecture from the prestigious, Polytechnic University Arqpoli. She recently moved to Tallahassee from Washington, D.C. where she completed an internship with the U.S. Department of Interior's National Park Service, documenting and drafting historic construction drawings and annotations to be published in the Library of Congress. Cristina brings unique talent and a strong work ethic, and we are pleased to include her on our team. She is currently in the FAMU Facilities Management Master's Program, focusing her studies on historic preservation and facilities management.

